

QTY.	PRODUCT	NEXT ASSY. DWG.	NO.	DESCRIPTION OF CHANGE	SCO#	DATE	BY
			0	NEW ISSUE		03/08/19	DSE
			1				
			2				
			3				
			4				

NO. RFT691/1100
 SUPSDS.

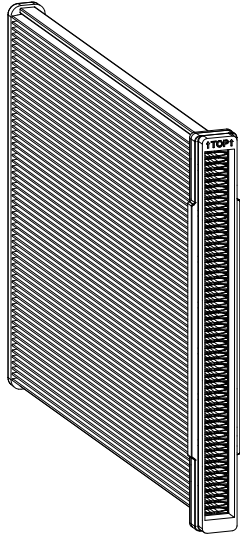

Compact Filter Element Type 83.1, PTF 24, Filtration of at least 99.995%, 64 pleats, approx. 30 mm Pleat Height, Hard PU top and bottom, aluminum side supports and affixed gasket.

It is recommended that the compressed air for the cleaning/purge cycle be set at 4 bar MAXIMUM.

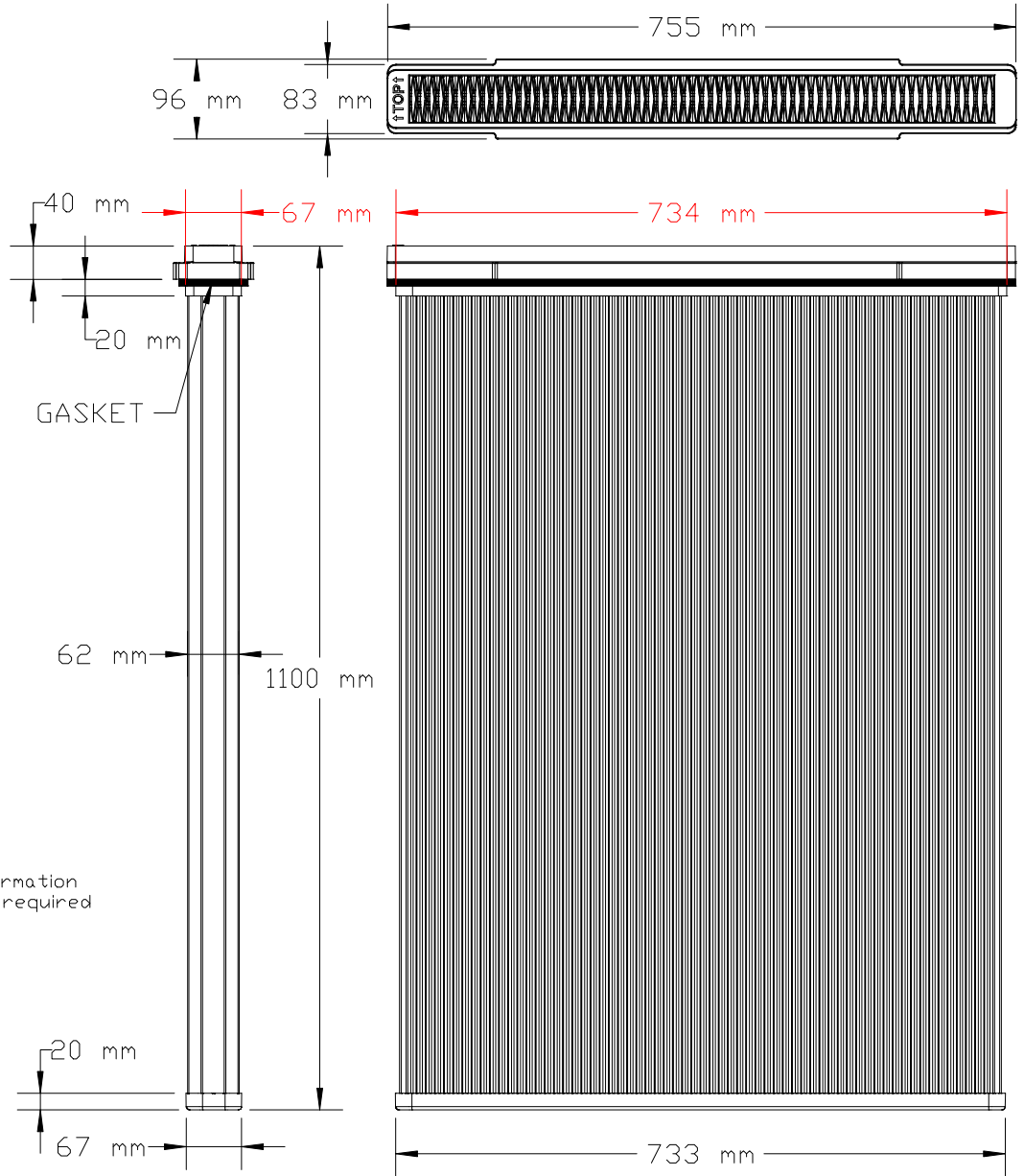

- NOTES:
- Includes mounting bars
 - Dimensions are for information purposes only & are not required for inspection purposes.



ITEM#	QTY	PART NUMBER	DESCRIPTION
TOLERANCES UNLESS OTHERWISE SPECIFIED FRACTIONS ±1/64 DECIMALS .X ±1 .XXX ±.005 ANGLES ±1/2° .XX ±.01 .XXX ±.005			THIS DOCUMENT IS THE PROPERTY OF RICHARDSON ELECTRONICS, LTD. AND SHALL NOT BE COPIED, REPRODUCED, USED IN THE MANUFACTURE OR SALE OF APPARATUS OR DISCLOSED TO OTHERS WITHOUT PERMISSION.
DO NOT SCALE DRAWING			Richardson Electronics, Ltd.
DRAWN	DSE	SCALE	NTS
ENG. MGR.		ENG. CHKD.	
ENG. MGR.		PRD. APPD.	
MAT'L			
MAT'L SPEC. NO.	—		
FINISH	—	PROD.	
			NO. RFT691/1100 CHANGE — 0

**DUST COLLECTION FILTER
 REPLACES TRUMPF P/N
 2260691**